

UNIDRIVE

With the universally applicable Unidrive screw wood wool panels can be easily screwed to wooden latticework or metal profiles. Moreover, you can also use our unidrive for standard mounting against concrete or limestone.



STANDARD VERSION

The unidrive screw is made of powder-coated steel with a standard surface treatment in corrosion class C4. The screws have a screw head with a wood fibre structure for a decorative finish. The Unidrive screws are supplied as standard in the colours white (RAL 9003) and nature tone (RAL 1015).

ADVANTAGES

- ✓ Universally applicable
- ✓ Textured screw head for decorative finishing
- ✓ Standard corrosion class C4

Unidrive Small (S) 3 panels

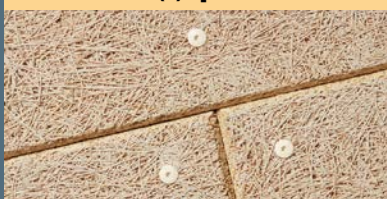

Unidrive Large (L) 3 panels



SPECIFICATIONS

	Screw diameter (mm)	Screw length (mm)	Panel thickness up to (mm)		Units/pack	Art. No. Nature tone	Art. No. White
			Concrete Limestone Wood	Metal			
Small	5.5	40	15	25	200	752458	752456
	5.5	50	25	35	200	752748	743448
	5.5	65	40	50	200	743395	743446
	5.5	80	55	65	200	752459	752457
Large	7.5	50	25	35	100	752461	752462
	7.5	75	50	60	100	752464	743447
	7.5	85	60	70	100	752751	752753
	7.5	100	75	85	100	752770	752771
	7.5	110	85	95	100	752774	752775
	7.5	125	100	110	100	752777	752778
	7.5	150	125	135	100	752783	752784
	7.5	175	150	160	100	752786	752787
	7.5	200	175	185	100	752789	752790
	7.5	225	200	210	100	752792	752793
	7.5	250	225	235	100	752795	752796

Always process our Heraklith wood wool panels according to our processing instructions. These can be found on heraklith.com/downloads

TECHNICAL INFORMATION

	Screw diameter 5.5 mm	Screw diameter 7.5 mm	Unit
Corrosion category	C4 >15jaar (1000h)		-
Tensile strength			
Concrete C20/25	0.78	0.66	kN
Limestone	0.25	0.22	
Wood	0.44	0.69	
Metal 0.6mm	0.13	0.17	
Metal 2.0mm	0.93	1.21	
Head diameter	14	18	mm
Borehole diameter	4	6	mm
Borehole depth (concrete/limestone)	30		mm
Anchorage depth			
Concrete / Limestone / Wood	25		mm
Metal	15		mm
Maximum metal thickness	0.6 - 2.5		mm
Propeller drive	Torx 25	Torx 30	-
Recommended drilling speed	1.500-2.500		rpm

Concrete

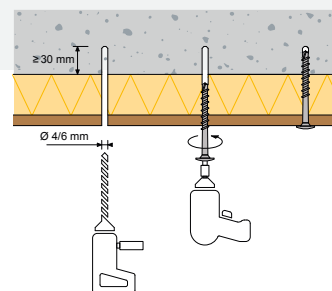

Wood

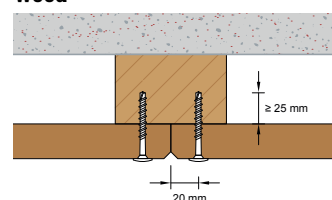

Metal

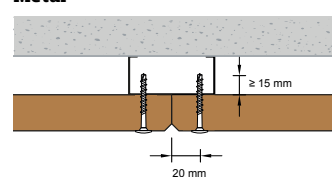

Durability	Corrosion class (ISO 12944-2)				Unit	Norm
	C2	C3	C4	C5		
2-5 years	-	120	240	720	h (salt spray test hours)	ISO 12944-2
5-15 years	-	240	480	1440		
> 15 years	-	480	720	2160		

Do you want more information? Please contact us

Knauf Insulation B.V.

Dakota 7
5126 RL Gilze

Tel: + 31 (0)162 - 42 12 45

e-mail: woodwool.export@knaufinsulation.com

www.heraklith.com

Our general sales and delivery conditions apply to all our offers, communications and agreements, notwithstanding any provision to the contrary that can be found on our order forms or elsewhere. An overview of our general terms and conditions can be found on: heraklith.com/downloads. Extreme caution was observed when putting together and processing the information, texts and illustrations in this document. Nevertheless, errors cannot quite be ruled out. The publisher and editors cannot assume legal responsibility or any liability whatever for incorrect information and the consequences thereof.

V2-UK 04/2023

Heraklith® is a registered trademark of

KNAUF INSULATION